

Which point on the number line best represents $\sqrt{12}$?

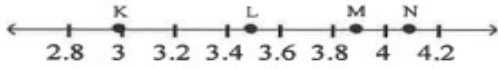

(a) If your answer is _____ draw the following hat on the head.	
(b) If your answer is _____ draw the following hat on the head.	

Donna's TV screen is 20 inches long. If the diagonal measures 25 inches, what is the width of Donna's TV?

(a) If your answer is _____ draw the following eyes.	
(b) If your answer is _____ draw the following eyes.	

The drawing below shows three squares joined at their vertices to form a right triangle.

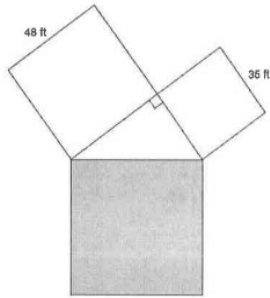

What is the area of the shaded region?

(a) If your answer is _____ draw the following hair.	
(b) If your answer is _____ draw the following hair.	

The Johnsons are thinking of building a bridge across their pond from point X to point Z, as shown in the figure below.

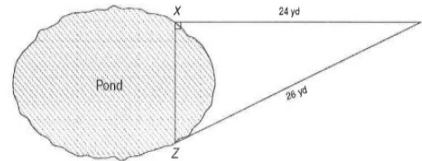

Which is closest to the distance from point X to point Z?

(a) If your answer is _____ draw the following eyebrows.	
(b) If your answer is _____ draw the following eyebrows.	

Mr. Elliott designed a flower garden in the shape of a square. He plans to build a walkway through the garden, as shown below.

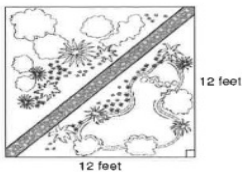

Which is closest to the length of the walkway?

(a) If your answer is _____ draw the following ears.	
(b) If your answer is _____ draw the following ears.	

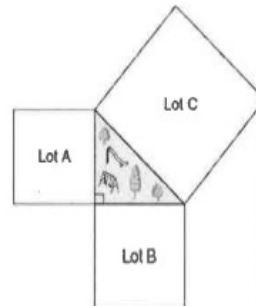



(a) If your answer is _____ draw the following nose.	
(b) If your answer is _____ draw the following nose.	



If parking lot A has a side length of 15 yards and parking lot C has an area of 625 square yards, then what is the perimeter of parking lot B?

Use the Pythagorean theorem to determine if a triangle with the given sides is a right triangle or not a right triangle.

$$a = 9, b = 40, c = 41$$



(a) If your answer is _____ draw the following smile.	
(b) If your answer is _____ draw the following smile.	

Melanie is making a piece of jewelry that is in the shape of a right triangle. The two shorter sides of the piece of jewelry are 9 mm and 12 mm. Find the perimeter of the piece of jewelry.

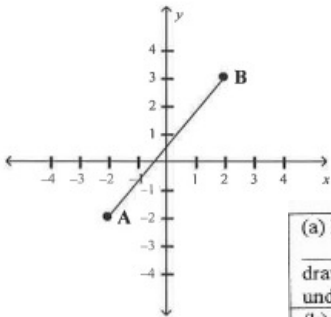

(a) If your answer is _____ draw the following lines and buttons on the shirt.	
(b) If your answer is _____ draw the following lines and buttons on the shirt.	

If $AB = \sqrt{41}$, the length of \overline{AB} is ____

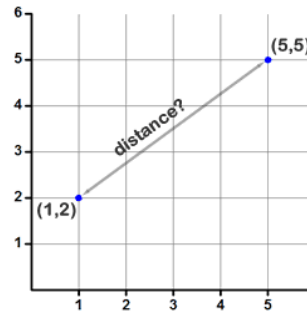

(a) If your answer is _____ draw a rectangle under EACH eye.	
(b) If your answer is _____ draw an oval under EACH eye.	



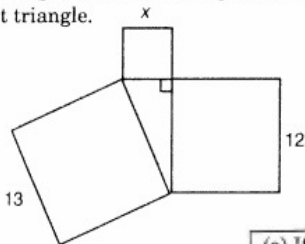

(a) If your answer is _____ draw the following baseball diamond, grass, and scoreboard in the background.	
(b) If your answer is _____ draw the following baseball diamond, grass, and scoreboard in the background.	

In the figure below, three squares form a right triangle.

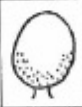

What is the value of x ?

(a) If your answer is _____ draw stubs of hair all over the chin and cheeks.	
(b) If your answer is _____ draw stubs of hair all over the neck and arms.	

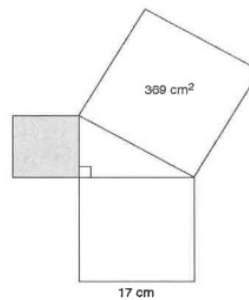

What is the area of the shaded square?

(a) If your answer is _____ draw a baseball in the background.	
(b) If your answer is _____ draw a baseball bat in the background.	